

SILVER SPRINGS CAMPGROUND

5238 Young Road • Stow, Ohio



330-689-5100



Site fees:

Stow Residents: \$13.00/night
Non-Residents: \$15.00/night



SILVER SPRINGS CAMPGROUND



REGISTRATION

Select a vacant campsite and set up camp. Fee will be collected later by the Park Attendant. **(No reservations.) You must register the first day.** Check-in deadline is 10:00 PM.

WELCOME

Thank you for coming to Silver Springs Campground. Your campsite includes a gravel parking pad, picnic table, 20-amp electric, and a fire ring/grill. The map on the next page will indicate the locations of the sites, water spigots, restrooms, trash dumpster, and trailer dump station. Also shown is the campground bulletin board (rules, notices, etc.) and the emergency telephone/first aid kit. Please take the time to become familiar with these at the *beginning* of your stay.

NEED HELP?

If a question arises during your stay, ask the Park Attendant. You may also call the Stow Parks & Recreation office at 330-689-5100 (Mon-Fri. 8:00 AM to 4:30 PM). During the evening or on weekends, call the Stow Police non-emergency number 330-689-5700. **For all emergencies, dial 9-1-1.**

PARK FACILITIES

Silver Springs Park offers many attractions, including the historic Heritage Reserve, a large fishing pond, dog park, picnic area with shelters, trails, children's play area, tennis/horseshoe/basketball courts, and more. Refer to the map at the center of this brochure for exact locations of these facilities.

For your biking pleasure, the Metro Parks Bike & Hike Trail is located just south of the park (off of Young Road), offering over 26 miles of trail. Trail maps are available from the Park Attendant.

Note: Because the park closes at dark, all after-dark activities are restricted to the immediate campsite area (no night hikes, night fishing, etc.).

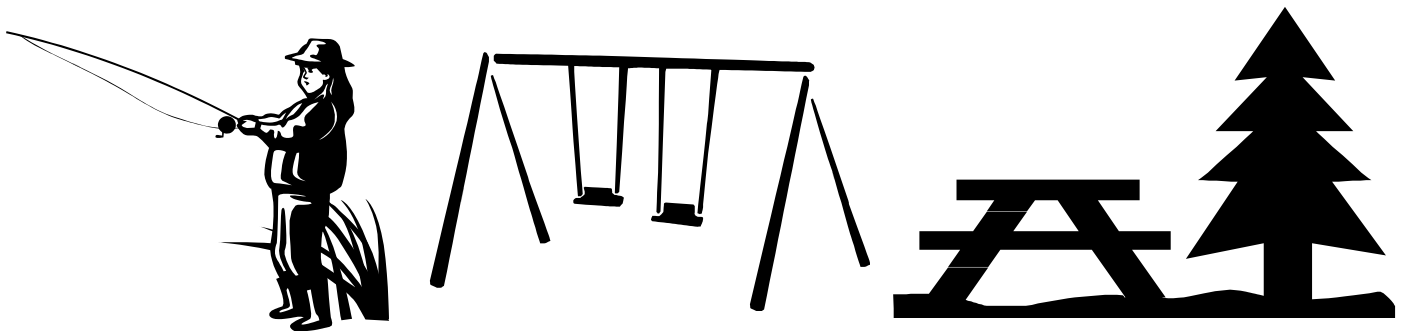

955.03**SAFETY RULES**

The Director of Parks and Recreation is authorized to adopt and enforce safety rules for the daily operation of municipal park and recreation areas by posting the same in a conspicuous place on the premises. (1979 Code 96.04)

955.06**CAMPING RULES FOR SILVER SPRINGS PARK**

- a) All regulations contained in Section 955.02 apply to the camp area. Unless authorized by the Parks and Recreation Board or the Director of Parks and Recreation, the following additional regulations are established for the campground:
- b) A camper shall register with the park attendant and obtain a camping permit. Upon receipt of the camping permit, the camper shall display the white copy on the dashboard of his vehicle. There shall be no refund of the paid permit fee.
- c) Only campers 18 years of age or older may register for a campsite. Any camper under 18 years of age shall be a member of a family unit or a chartered organization under adult supervision.
- d) A camper can register for only one campsite. A camper cannot register for another person. No person shall sublease, transfer, or assign his campsite to another person.
- e) Camping is permitted only in designated areas and is limited to no more than five (5) days on one campsite, after which the permittee must change sites. A permittee may camp a maximum of fifteen (15) days within a thirty (30) day period.
- f) The campsite shall be vacated by 4:00 PM on the day on which the permit expires, and thereafter, one extra night's fee shall be charged.
- g) A campsite may not be occupied by more than six persons, unless all are members of the same immediate family (registered father and/or mother and their children).
- h) A campsite shall not contain more than:
 - (1) One tent or tents having a separate or combined floor space not in excess of 200 square feet; or
 - (2) One recreation vehicle (no vehicle may be more than 35 feet in length) in combination with a tent or tents as limited in division (h)(1) of this section
 - (3) One motor vehicle, in addition to one of the vehicles mentioned in (h)(2) may be parked on the site parking pad for daily transportation use, except that two motorcycles may be parked on the site parking pad in lieu of other vehicles.
- i) Campers shall register the first night. After a 24-hour period of nonpayment or non-registration, it shall be considered a violation which will be cause for revocation of the camping permit and removal of property.
- j) Every user of the camp area facilities shall hold a valid camping permit or shall be the invited guest(s) of permittees.
- k) Camp area visiting hours are 8:00 AM to 10:00 PM. Registered campers shall register their guests with the Park Attendant. Registered campers are responsible for the actions of any visitors to their campsites.
- l) No person shall linger or loiter about campsites or the general camping area without being the invited visitor of a permittee. All other persons, unless conducting business therein at the request of the City, shall be subject to removal or arrest herein or as an unauthorized trespasser.
- m) No person shall engage in conduct which disturbs the property of another or which is quarrelsome, boisterous, noisy, profane, obscene, or which threatens or menaces another.
- n) Noise shall be kept to a minimum, particularly between the hours of 10:00 PM and 8:00 AM. Parents are responsible for the behavior and safety of their children.
- o) Dogs or other pets are permitted, but must be leashed.
 - (1) Only pets of registered campers are permitted on their sites.
 - (2) Pets shall not be left unattended.
 - (3) Pets may be walked/exercised on a leash in Silver Springs Park.
 - (4) All pet litter shall be cleaned up immediately and properly disposed of.
 - (5) Noisy, disturbing, or vicious pets shall not be permitted to remain on a site. (Ord. 2008-63. Passed 3-14-08.)
- p) Wastewater from trailer sinks and showers not held in trailer holding tanks shall be disposed of in wastewater drains, toilets, or trailer waste dump stations. Waste from trailer toilets shall be held in trailer holding tanks which are properly sealed, and these wastes disposed of only at a trailer waste dump station. This is in compliance with State Sanitary Code Regulations OAC 3701-25-59 et. Seq. and Ohio R.C. 3733.08.
- q) Sites shall be cleaned daily. Litter and debris shall be placed in the trash dumpster/receptacles provided
- r) Fires are permitted only in stoves, grills, or designated areas. All fires shall be kept at a minimum size. Check for fire bans before starting any fires.
- s) Campfires shall be totally extinguished before leaving the campsite or retiring.
- t) The collection of firewood or cutting of trees for firewood is strictly prohibited. Defacing of trees is forbidden. This includes cutting, driving nails, attaching clotheslines, or other objects to trees.
- u) Violators of the above regulations shall be subject to the immediate removal from the campground area, and to prosecution hereunder. In this respect, all reasonable requests of the park attendant shall be complied with in maintaining peace and order within the camping area. (1994-134. Passed 4-28-94.)

955.99**PENALTY**

- a) Whoever violates any provision of this chapter for which another penalty is not already provided is guilty of a minor misdemeanor. Each day's violation shall constitute a separate offense.
- b) Violation of any of the provisions of Section 955.02 except as stated in subsection © hereof, or any specific facility or activity regulation shall be deemed a minor misdemeanor for the first offense and a misdemeanor of the third degree for each subsequent offense.
- c) Violation of the provisions of Section 955.02(a)(2) and (3) hereof shall be deemed a misdemeanor of the third degree (1979 Code 96.99)

GENERAL REGULATIONS

- (a) Unless authorized by the Parks and Recreation Board or the Director of Parks and Recreation, the following general regulations are established for all municipal park and recreation areas.
- (1) No person, group or organization shall use any baseball diamond without obtaining authorization therefore.
 - (2) No person shall pick any flower, whether wild or domestic, remove any plant, shrub, bush, tree or the like, or break, puncture, or otherwise damage the trunk or any branch of a tree within any municipal park or recreation area.
 - (3) No person shall purposefully or knowingly deface, tear down, demolish, injure or destroy, either in whole or in part, any facility or property within any municipal park or recreation area.
 - (4) No person shall build or ignite any fire except within grates, fireplaces or other facilities provided by the Board therefore. (Ord. 1988-142. Passed 5-26-88.)
 - (5) No person shall take any pet, whether on a leash or otherwise, into any park area, shelter or facility, with the following exceptions:
 - A. Pets are permitted on the Bike and Hike Trail and at the campground if they are controlled at all times on a leash held in hand. Leashes shall not be longer than eight feet.
 - B. Pet litter shall be picked up and properly disposed of by the pet owner. (Ord. 1997-59. Passed 2-27-97.)
 - C. For the purpose of taking a dog to the Silver Springs Dog Park, dogs shall be permitted in Silver Springs Park while leashed. Once inside the designated area within the dog park, a dog may be unleashed and remain so until exiting the dog park. The Director of Parks and Recreation is hereby authorized to designate specific areas of the dog park for leashing and unleashing dogs.
 - D. Dogs 35 pounds or under will have the option of being separated from larger dogs in the dog park.
 - E. Any and all funding for the dog park will come from Stow Parks and Recreation's Cell Tower Fund.
 - F. This legislation will come up for review by Council on a yearly basis to make sure that it is complied to in all aspects, at which time Council reserves the right to rescind this legislation for non-compliance.
 - G. The park will be closed any time the lake is in the freezing process or frozen. (Ord. 2007-66. Passed 4-13-07.)
 - (6) No person shall take beer, liquor, wine, regardless of alcoholic content, into any park area, shelter or facility with the exception of Silver Springs Lodge and Heritage Barn when permitted.
 - (7) The following provisions shall govern the use of beer, liquor or wine on park property:
 - A. No person shall sell beer, liquor or wine, regardless of alcoholic content, in any park area, shelter or facility. For the purposes of this regulation, "sell" includes the exchange, barter, gift or solicitation of donations in exchange for the distribution or delivery of beer, wine or liquor, all as those terms are used in Ohio R.C. 4301.01.
 - B. The consumption of beer, liquor or wine shall be permitted inside Silver Springs Lodge and Heritage Barn, upon a request being filed therefore by the applicant, and written approval being received from the Director of Parks and Recreation, and the posting of a cash bond in an amount of \$200.00 to cover any damaged, stolen or misplaced equipment or property arising out of the use of the premises at any time that alcohol is being consumed.
 - C. The applicant shall be held responsible for all of the above.
 - D. No person from Silver Springs Lodge or Heritage Barn shall take into any other park area, shelter or facility, or consume in any other park areas, shelter or facility, any beer, liquor or wine, regardless of alcoholic content.
 - E. Any person consuming alcoholic beverages or permitting them to be consumed without approval or a cash bond shall be in violation of subsection (a)(7) hereof, which will be considered a first degree misdemeanor.
 - (8) No person shall take or discharge any gun, revolver, air or gas rifle or pistol, or slingshot, into any park area, shelter or facility.
 - (9) No person shall drive, move, operate or ride any bicycle, motorcycle or motor-vehicle, as those terms are defined in Chapter 301 of the Traffic Code, or any other humanly or mechanically propelled apparatus upon park or recreation land so as to interfere with the safe, peaceful and reasonable use of the land and the facilities thereupon by any other person. The vehicles or apparatus shall be operated only in areas commonly designated as being appropriated therefore, such as roads, parking areas, and bike trails, by the Director of Parks and Recreation and shall not be operated in other park or recreation areas commonly attracting and accommodating the public for the safe leisure or play of persons free from the interference of these devices.
 - (10) No person shall drive any vehicle off designated roads in any public park other than a City maintenance vehicle in designated picnic area.
 - (11) No person shall ride, lead or transport a horse into a City park.
 - (12) All park grounds are closed to the public after the security lights turn on, with the exception of lodge users and their guests in the immediate lodge area only, individuals with a written permit, organized ball games, campground activities, activities at the historical house and tennis players using tennis courts while lit.
 - (13) No person shall hunt, pursue with dogs, trap or in any other way molest any wild bird or animal found within the confines of the park, or therein rob or molest any bird nest or take the eggs of any bird.
 - (14) No person shall fish or take in any manner any fish or other natural life from the waters of the parks, except in designated areas.
 - (15) No person shall establish or maintain any camp or other temporary lodging place, except in designated areas.
 - (16) No person shall, either by word or act, indulge in any noisy, boisterous, disorderly or indecent conduct, or in any manner disturb the peace or good order of the community within the park; nor shall any person engage in any active game endangering other persons in the park; nor shall any person play at games of chance, drinking intoxicating liquor or be drunk or do any indecent, lascivious, lewd or improper act therein. No person shall enter a toilet room set apart for the opposite sex.
 - (17) No person shall expose, distribute or place any sign, advertisement, circular, notice or statement, or display any banner, emblem or design within the parks.
 - (18) No person shall sell or offer for sale any article, thing, privilege or service within the parks without a permit from the Board, and no person shall do any begging, hawking, peddling or soliciting.
 - (19) No person shall fail or refuse to comply with any reasonable order relating to the regulation, direction or control of traffic, or to any other order lawfully given by any police officer acting under the authority of the Board, or willfully resist, obstruct or abuse any security person or other official in the execution of his office.
 - (20) The use of bows and arrows in the parks is prohibited except in areas designated by the Department as archery ranges.
 - (21) No person shall abandon, or permit abandonment, of any household pet or other domestic animal in the parks. (Ord. 1988-142. Passed 5-26-88.)
 - (22) No person shall solicit donations or collections without first obtaining written permission of the Park Department in accordance with the rules and regulations set therefore. (Ord. 1995-241. Passed 9-28-95.)
 - (23) No person shall loiter in or near any building, structure or motor vehicle in the parks.
 - (24) No person shall ride or operate a vehicle of any kind, including bicycles, on the park trails. Trails throughout the parks are for pedestrian use only.
 - (25) Sledding, ice skating, and other related winter sports and activities are permitted in designated areas only, and only during periods when these activities are deemed safe.
 - (26) The playing of radios tape decks and record players is permitted only for the enjoyment of the individual, and the volume shall, at all times, be maintained at a level which will not disturb or be offensive to other park visitors.
 - (27) No person shall operate a snowmobile, all-terrain vehicle, minibike, go-kart, vehicle normally considered as a racing car, or any other type of motor vehicle not customarily registered or titled with the State Department of Motor Vehicles in the parks.
 - (28) No person shall wash or repair a car, truck, or any other motor vehicle in the parks.
 - (29) The parking of any motor vehicle is permitted only in parking areas provided for that purpose.
 - (30) Swimming is permitted only in designated areas supervised by the Department
 - (31) Driving, putting, or any form of golfing is not permitted in any park area.
 - (32) All park users shall be subject to the special rules or regulations governing certain activity areas of the park, such as swim lake, campgrounds, ball diamonds or lodges.
 - (33) All motorized vehicles are limited to a ten-mile per hour speed limit while passing on or through a road in any park.
 - (34) No person shall throw or deposit any can, debris, paper, foodstuff, bottle or any other kind of trash or discarded commodity onto park property.
 - (35) Bicycles ridden after dark shall have proper lighting as stated in Ohio R.C. 4513.11.
 - (36) The collecting of firewood or cutting of trees for firewood is strictly prohibited.
 - (37) No persons shall linger or loiter about campsites or the general camping area without being the invited visitor of a permittee. All other persons, unless conducting business therein at the request of the City, shall be subject to removal or arrest herein under or as an unauthorized trespasser.
 - (38) Any person engaging in conduct which disturbs the property of another or who is quarrelsome, boisterous, noisy, profane, obscene or who threatens or menaces another shall be subject to immediate removal from the park area, and to prosecution hereunder. In this respect, all reasonable requests of the park attendant shall be complied with in maintaining peace and order within the park area.
 - (39) Pursuant to Chapter 335 of the Traffic Code all motorized vehicles which are operated in permitted areas of Silver Springs Park shall be properly licensed by the State and the operators of the vehicles shall be duly licensed to operate such vehicles.
- (b) The Parks and Recreation Department shall not be responsible for damages incurred to personal or private property when in use or parked upon parkland. (Ord.1988-142. Passed 5-26-88.)

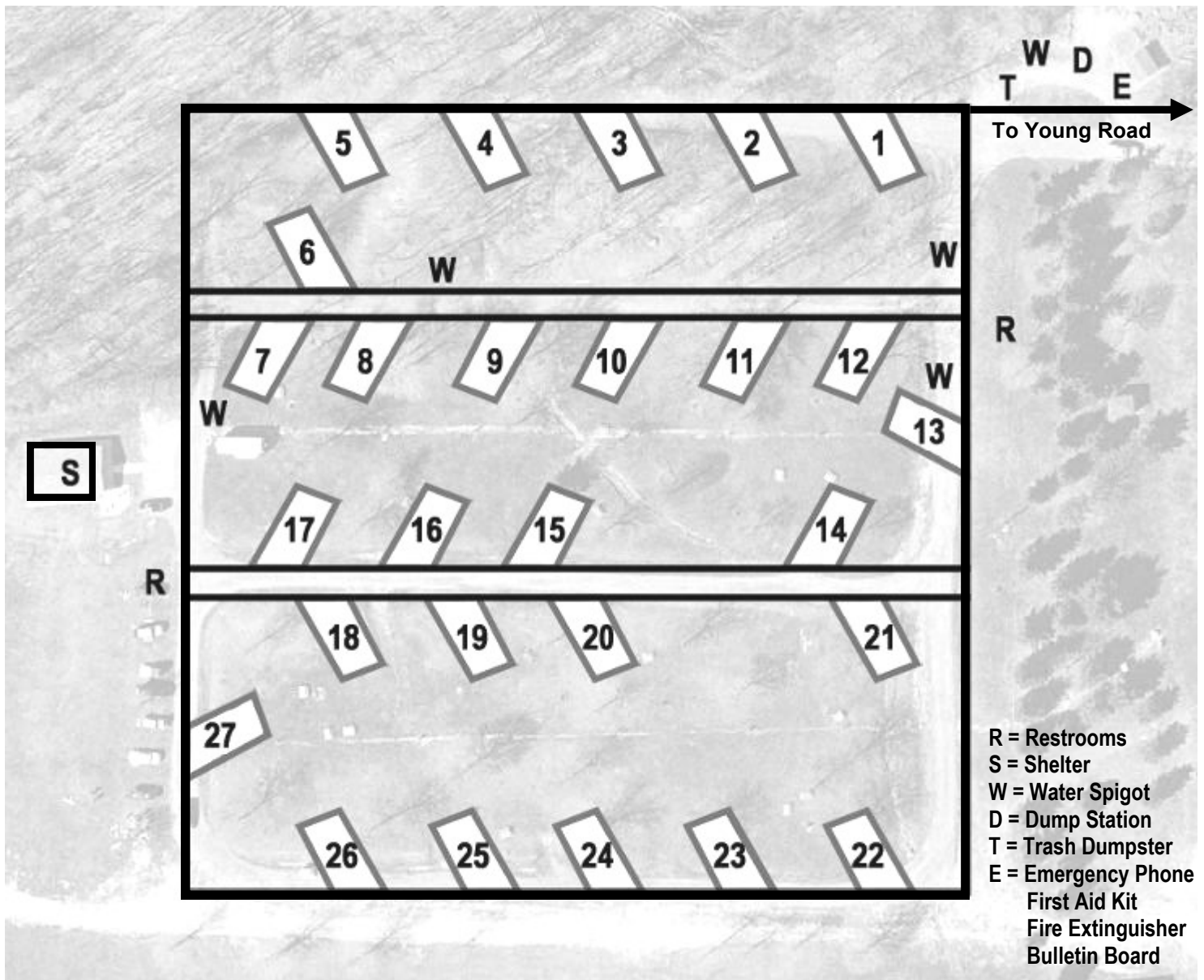

MAPS & INFORMATION

Maps of Stow are available from the Park Attendant. If you need information concerning local activities/events, check the bulletin board or ask the Park Attendant.

ADDITIONAL INFORMATION

- Please back into your campsite, so that your vehicle/unit faces the road.
- Do not collect firewood from the woods. Firewood is available from the Park Attendant for a modest fee.
- Do not move picnic tables around. Keep two tables per campsite.
- The drinking water supplies are NOT to be used as permanent hookups. The dump station spigot is for rinsing out trailer holding tanks ONLY. All other spigots are for drinking water. No dishwashing, bathing, etc. is permitted at the water spigots.
- Place all trash into the trash dumpster before retiring or vacating your campsite. Do NOT place trash in grills. Dump all dishwater into the wastewater drains around the perimeter of the campground. This will help to keep nocturnal animals and pests away from your sites. Keep your campsite clean!
- Please read the enclosed rules and regulations. These are conditions of your permit. Violators of these rules shall be subject to immediate removal from the campground (without refund) and/or to prosecution.

***Your cooperation will help assure a pleasant camping experience for you and your neighbors.
Thank you!***

SILVER SPRINGS

City of Stow, Ohio

1. Soccer Fields
2. Silver Springs Lodge
3. Basketball/Tennis Courts
4. Horseshoe Pits
5. Dog Park
6. Lakeview Shelter
7. S.O.A.R. Playground
8. Oak Tree Shelter
9. Trailhead (two trails)
10. Baseball Fields
11. Campground
12. Heritage Reserve

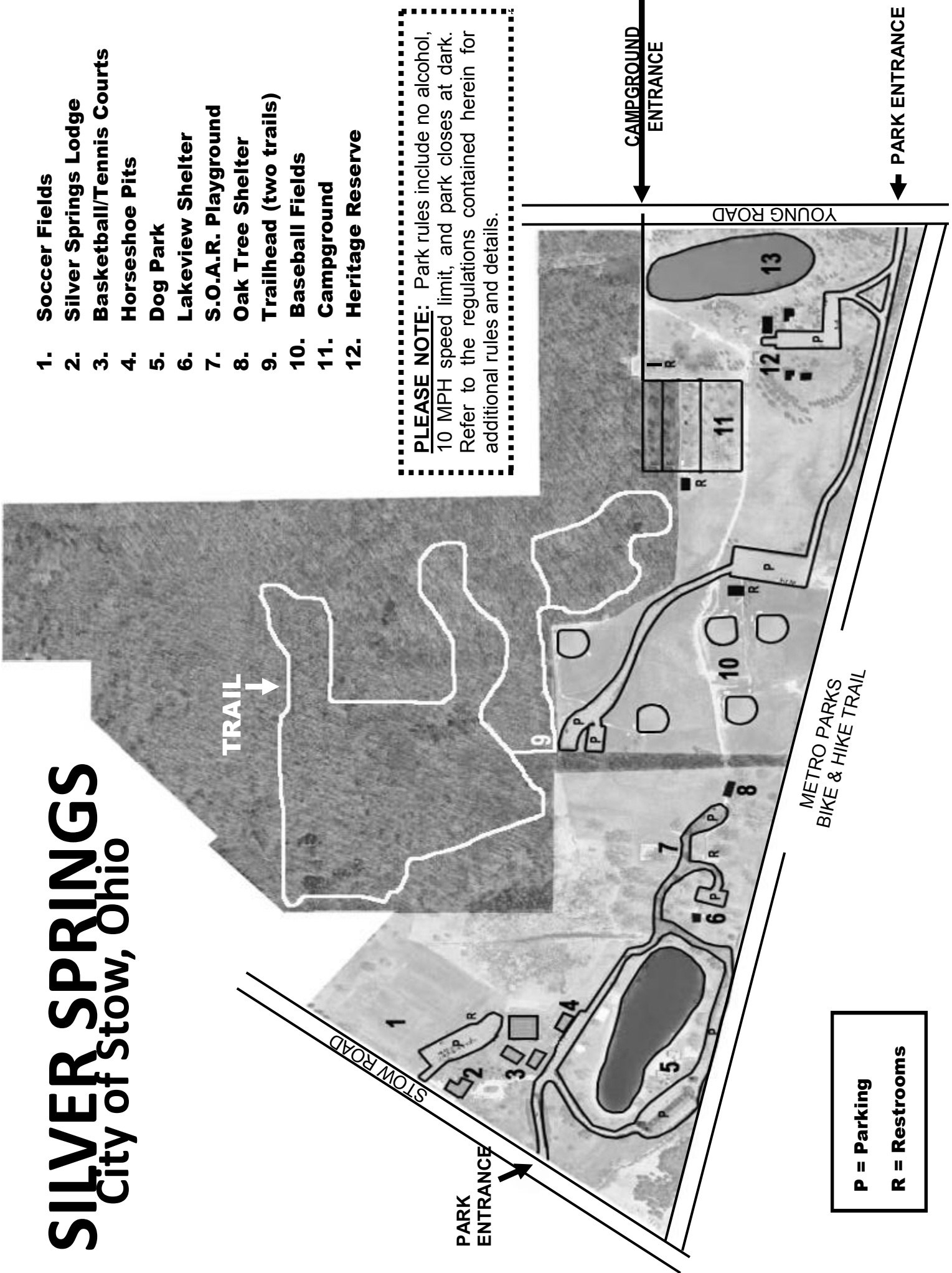

PLEASE NOTE: Park rules include no alcohol, 10 MPH speed limit, and park closes at dark. Refer to the regulations contained herein for additional rules and details.

P = Parking
R = Restrooms

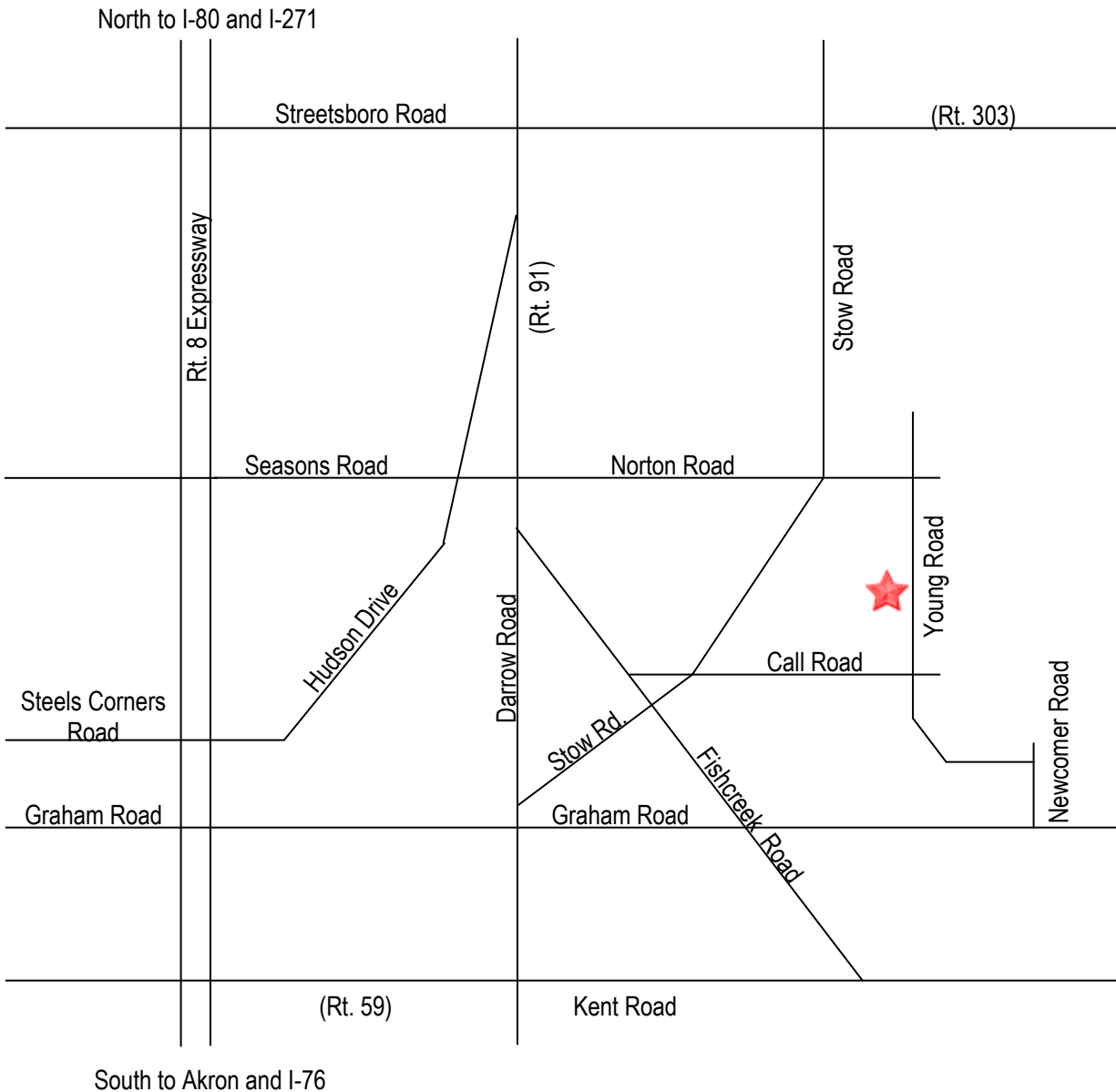

DIRECTIONS

(We are located about 7 miles NE of Akron)

FROM AKRON, or South: Rt. 8 Expressway, right on Seasons Rd. (becomes Norton Rd.), right on Young Rd. to campground entrance.

FROM HUDSON, or North: Darrow Rd. (Rt. 91) or Stow Rd., left on Norton Rd., right on Young Rd. to campground entrance.

FROM KENT, or East: Kent Rd. (Rt. 59), right on Fishcreek Rd., right on Stow Rd., right on Call Rd., left on Young Rd. to campground entrance.

FROM CUYAHOGA FALLS, or West: Kent Rd. (Rt. 59) or Graham Rd., left on Darrow Rd. (Rt. 91), right on Stow Rd., right on Call Rd., left on Young Rd. to campground entrance.

FROM I-76, I-80, I-271, etc.: Connect to Rt. 8 Expressway, east on Seasons Rd. (becomes Norton Rd.), right on Young Rd. to campground entrance.

Thank you for visiting!